

KNIFE GATE VALVE

AL 48-B4400

Non rising stem
Bi-directional tightness

Description

AL 48-B4400 is a bi-directional tight knife gate valve with non rising stem for on-off applications.

- Wafer mounting PN10
- Connection between flanges according to EN 1092-2 and DIN 2501
- The valve can be installed in any position, but vertical position in horizontal pipelines is recommended.
- Complete sealed by Nitrile elastomer seat in standard
- Epoxy coated body RAL 6005, thickness 150 microns
- Handwheel operation
- Face-to-face dimension according to standard EN558 serie 20
- Test procedures are established according to standards EN 12266-1, DIN 3230, BS 5154 and ISO 5208
- Optional: DN 450-600 with gearbox, type AL 48-B4400-08

Pressure/Temperature

| | |
|----------------------------------|-------------------|
| Maximum temperature: | -10°C - +80°C |
| Maximum working pressure: | DN 50-250: 10 bar |
| | DN 300-450: 7 bar |
| | DN 500-600: 4 bar |

Approvals

CE/PED 2014/68/EU

Dimensions

| DN | L | B | C | H | Ø K | Ø V | n | Ø M | Weight kg |
|-----|-----|-----|-----|------|-----|-----|----|----------|-----------|
| 50 | 43 | 126 | 63 | 283 | 125 | 200 | 4 | 4 x M16 | 9 |
| 65 | 46 | 140 | 69 | 308 | 145 | 200 | 4 | 4 x M16 | 10 |
| 80 | 46 | 154 | 91 | 333 | 160 | 200 | 8 | 4 x M16 | 11 |
| 100 | 52 | 177 | 104 | 378 | 180 | 200 | 8 | 4 x M16 | 14 |
| 125 | 56 | 198 | 119 | 423 | 210 | 250 | 8 | 4 x M16 | 18 |
| 150 | 56 | 220 | 131 | 474 | 240 | 250 | 8 | 4 x M20 | 21 |
| 200 | 60 | 275 | 158 | 593 | 295 | 310 | 8 | 4 x M20 | 34 |
| 250 | 68 | 326 | 197 | 685 | 350 | 310 | 12 | 8 x M20 | 51 |
| 300 | 78 | 380 | 231 | 792 | 400 | 310 | 12 | 8 x M20 | 69 |
| 350 | 78 | 450 | 257 | 900 | 460 | 500 | 16 | 10 x M20 | 123 |
| 400 | 102 | 510 | 292 | 978 | 515 | 500 | 16 | 10 x M24 | 156 |
| 450 | 114 | 563 | 311 | 1105 | 500 | 565 | 20 | 14 x M24 | 200 |
| 500 | 127 | 626 | 344 | 1215 | 500 | 620 | 20 | 14 x M24 | 236 |

Part-/Material specification

| No | Qty | Part | Material |
|----|-----|-----------------|---------------------------|
| 1 | 1 | Body | Ductile iron EN-GJS-500-7 |
| 2 | 1 | Seat | NBR |
| 3 | 1 | Gate | Stainless steel 304 |
| 4 | 4 | Packing | PTFE |
| 5 | 2 | O ring | NBR |
| 6 | 1 | Gland packing | Ductile iron EN-GJS-500-7 |
| 7 | 1 | Stem | Stainless steel 304 |
| 8* | 2 | Support plate | Steel A45 |
| 9 | 1 | Nut support | Bronze |
| 10 | 1 | Friction washer | Bronze |
| 11 | 1 | Lubricator | Stainless steel 304 |
| 12 | 1 | Nameplate | Stainless steel 304 |
| 13 | 1 | Handwheel | Cast iron EN-GJL-250 |

* Pre-shaped parts up to DN 300

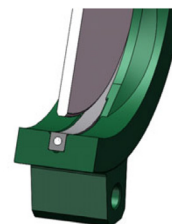

Tightness in both
flow directions

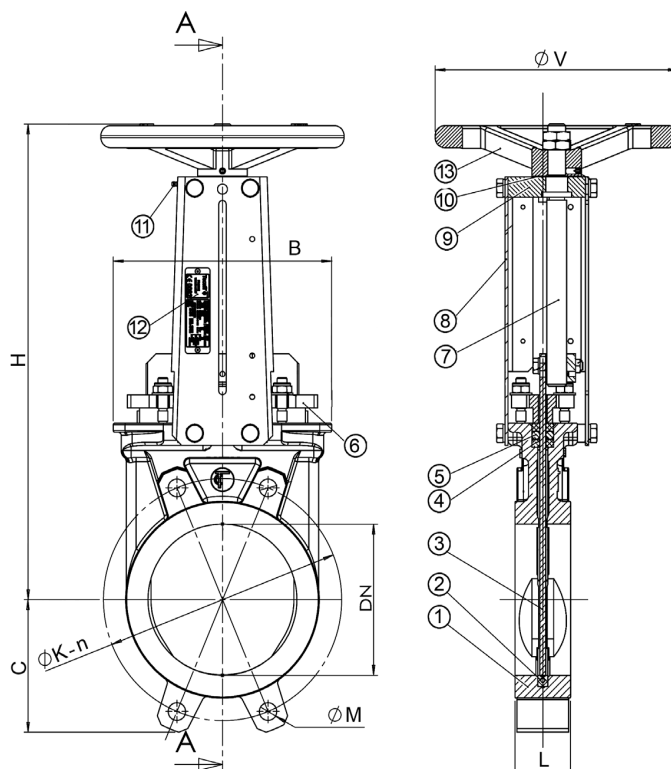

AXEL LARSSON

Telephone +46 10 455 97 00 • sales@axel-larsson.se • www.axel-larsson.se

Head Office: Truckvägen 12, P.O. Box 805, SE-194 28 Upplands Väsby (Stockholm), Sweden.